



Installation Instructions



NOTE: All electrical work must be carried out by a licensed electrician as per the latest AS 3000 wiring regulations.
WARNING: All maintenance is to be performed by the supplier, a service agent or qualified person.
 The luminaire must be operated within its specified operating parameters and in accordance with our warranty requirements.
Note: Regularly discharging the batteries (e.g during construction stage) will significantly shorten the battery's lifespan.
 Product failure as a result of this is strictly **NOT COVERED UNDER WARRANTY**.
 These documents are available on our website

INSTALLATION



Remove the mounting bracket by inserting a screwdriver into the locking tab



Place the mounting bracket at the ceiling/wall location, allowing 50mm on each side for its sliding mechanism. Mark the position of the screw holes and cable entry through the bracket

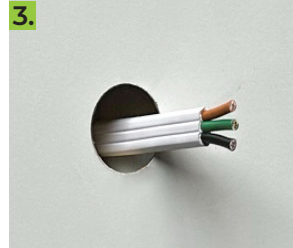

Remove the bracket to show the hole markings. Drill mounting holes and a 20mm hole for the cable entry

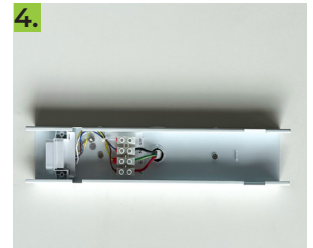

Feed the cables through the holes of the mounting bracket, secure bracket to surface and connect the cables to the terminal block



Slide the fitting into the mounting bracket by holding the unit horizontal to parallel with the bracket. Ensure the metal lugs line up



Fit the side of the fitting into the slot of the bracket first, then slide the unit in until it locks



Decals can be fitted by gently inserting the tabs into the 6 slots under the diffuser



After installation, this fitting is now a fully operational emergency light, please check indicators on the side of the fitting.

INITIAL LED INDICATORS

Applicable first 24hrs only

| Status | Charge Indicator | |
|--------------|------------------|-----------------------|
| White LED on | Red LED on | Battery charging |
| White LED on | Green LED on | Battery fully charged |
| White LED on | Red LED flashing | Battery not detected |
| LED off | LED off | Power not detected |



enLink-Exit-SC

Installation Instructions

Once powered up, enLink fittings automatically connect to each other and the gateway to form a secure network.











The naming and location of the fittings will be undertaken via the web interface by enLighten.

This fitting will automatically perform a 120-minute commissioning test 16-24hrs after first power-up.

This fitting will perform regular 90-minute duration tests automatically at pre-programmed monthly intervals, unless user-scheduled.

Test results can be viewed via the web interface or LED indicators on the fitting as shown below.

SELF-TEST FUNCTION STATUS INDICATORS

| Status | Charge Indicator | |
|--|--|---|
|  Blue LED flashing |  Blue LED flashing | Test in progress |
|  Blue LED on |  Red LED on | Fitting passed last self test, battery charging |
|  Blue LED on |  Green LED on | Fitting passed last self test, battery charged |
|  Blue and Red LED flashing alternately | | Battery self test failed, requires battery change |
|  Yellow LED flashing | | LED fault detected |
|  LED off |  LED off | Power disconnected or controller failed |

BATTERY REPLACEMENT

Only replace the battery with an enLighten replacement battery – part no. enLink-Batt-S1. Failure in doing so will void all warranty and manufacturer liability as a result of user negligence.

Dispose of the old battery properly by taking it to a designated recycling facility for batteries

DIMENSIONS

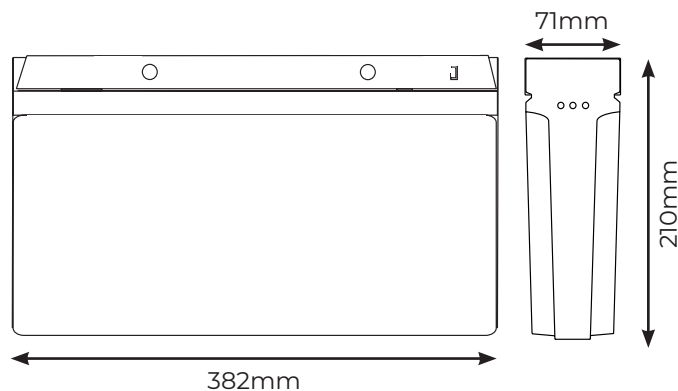

Subject to change
June 2024



enLink™ Weatherproof Box

Safe, Connected, Simple

enLink-SCExit-WPB



Installation Instructions



NOTE: When installing, ensure to use cable glands or silicone on any cable penetration into the waterproof enclosure

WEATHERPROOF BOX INSTALLATION



Undo all 4 bolts to open box

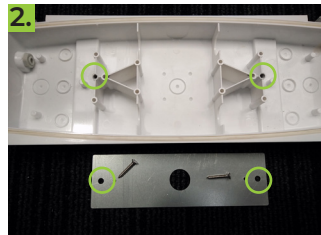

Align mounting plate over the outside centre holes.

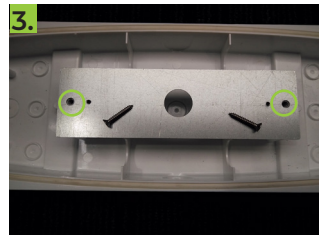

Install the two larger screws to fix in place

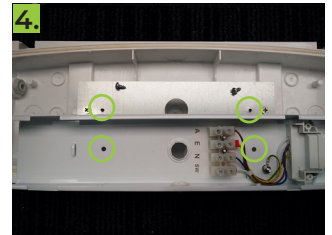

Align the 2 mounting holes of the exit sign over the holes of the mounting plate



Install the two smaller screws to fix in place

WEATHERPROOF BOX MOUNTING

Ceiling / Suspended Mount

Wall Mount

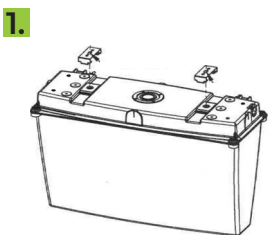

Mount suspension clips to ceiling and attach to WPB

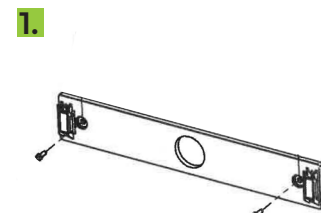

Mount bracket to wall

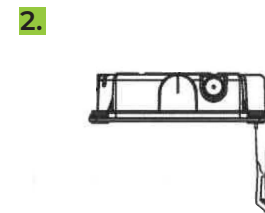

Remove diffuser and slide down onto wall bracket clip

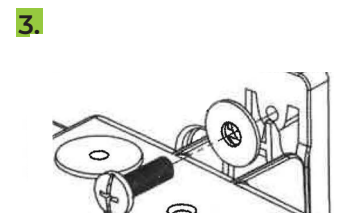

Using the screws and washers provided, secure onto wall mount

DIMENSIONS

