

Chamaeleon Deco 2

Emergency D2-CHAM-E

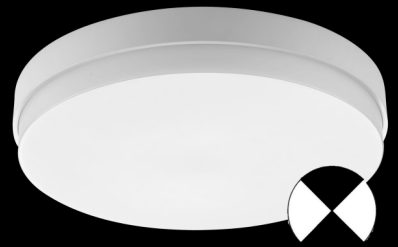

Installation Instructions



NOTE: All electrical work must be carried out by a licensed electrician as per the latest AS 3000 wiring regulations.
WARNING: All maintenance, including battery change on this luminaire, is to be performed by qualified personnel only.
De-energize all supplies before maintenance. This luminaire contains non-user replaceable lamps.

The light must be operated within its specified operating parameters and in accordance with our warranty requirements. These documents are available on our website. This fitting is rated IP44 and must not be mounted in locations exposed to rain and high humidity. This fitting will operate as a motion sensor fitting, the motion sensor can not be disabled.

Mounting



Remove the diffuser by twisting off.

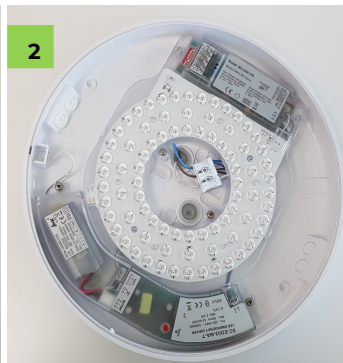

Feed cables through the base and mount the base to the ceiling. Alternatively the conduit entries on the side may be used. If there is an earth wire, it should be terminated



Connect the wires into the push terminals. **Neutral** wire into terminal "**N**", **permanent active** into terminal "**1**", **switched active** in terminal "**2**".

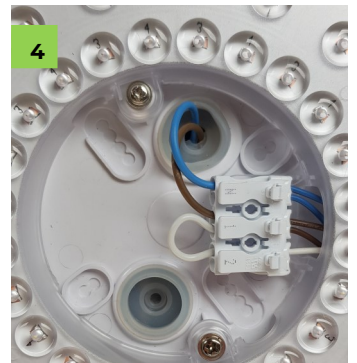

If only permanent active is available, connect **permanent active** into terminal "**1**" and insert a wire loop between terminals "**1**" and "**2**".

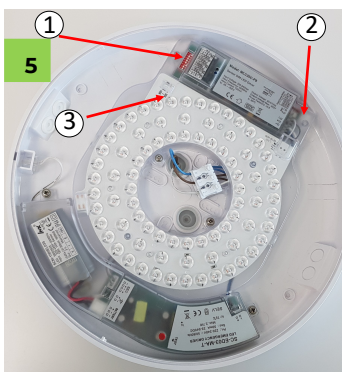

Adjustments:
(1) Microwave sensor settings
(2) Power settings
(3) Colour temperature
For details refer below.



Open the battery compartment and connect the battery to the charging board.
Note the date of commissioning on the battery.



Twist the diffuser onto the base.

Adjusting the colour temperature

The colour temperature of this fitting can be set to 3000K (warm white) or 4000K (neutral white). The default setting is **4000K**.

To change the colour temperature, set the dipswitch to the desired setting. This should only be done with power to the fitting switched off.



Adjusting the full light output

The full light output of the fitting can be changed from 100% to 70% or 50%. The default setting is **100%**. To change the setting, adjust the dipswitches as shown below. This should only be done with power to the fitting switched off.

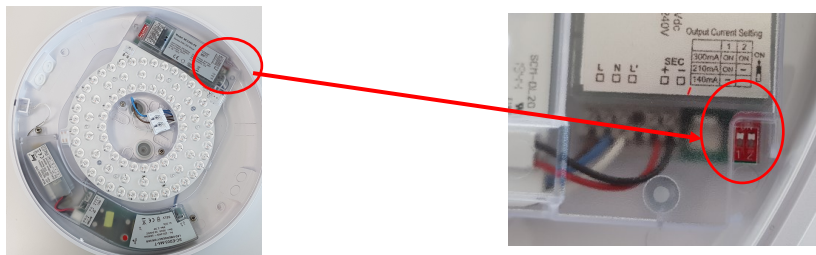

Full light output		
Dipswitch ->	1	2
100%	ON	ON
70%	ON	OFF
50%	OFF	OFF

Dip switch settings referred to below

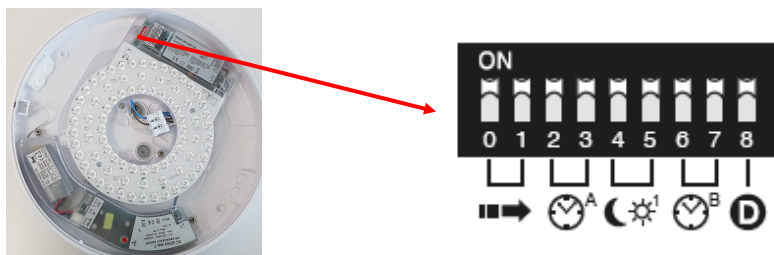

Microwave sensor detection range

The detection range/sensitivity of the sensor may be adjusted if required. Default setting is **100%**.

Sensor range		
Dipswitch ->	0	1
100%	ON	ON
50%	ON	OFF
25%	OFF	ON
10%	OFF	OFF

Daylight sensor

The daylight sensor may be used to switch the fitting off when there is sufficient natural light in the area.

When the daylight level drops below the "ON" value, the fitting will turn on at the standby level and the microwave sensor becomes active.

When the daylight level exceeds the "OFF" value, the light switches off.

The "disable" setting disables the daylight sensor.

Default setting is **disabled**.

Daylight sensor			
ON	OFF	4	5
5lux	25lux	ON	ON
25lux	75lux	ON	OFF
50lux	150lux	OFF	ON
Disable	Disable	OFF	OFF

Light operational settings

Hold time

Hold time is the time the fitting remains at 100% brightness after motion is no longer detected. Default setting is **1min**.

Hold time		
Dipswitch ->	2	3
5s	ON	ON
1min	ON	OFF
5min	OFF	ON
10min	OFF	OFF

Standby time

Standby time is the period the fitting remains at the standby level before it switches off.

If the standby level is set to *infinity*, the fitting always remains at standby level when the area is unoccupied. Default setting is **infinity**.

Standby time		
Dipswitch ->	6	7
0s	ON	ON
10min	ON	OFF
30min	OFF	ON
Infinity	OFF	OFF

Standby level

The standby level is the lower brightness level. When standby time is set to *infinity*, the standby level will be 10% and cannot be changed. Default setting is **10%**.

Standby level	
Dipswitch	8
10%	ON
25%	OFF

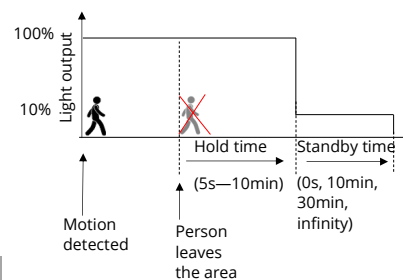

Application examples

The settings marked in green can be selected to achieve the functions mentioned below.

Stairs and corridors

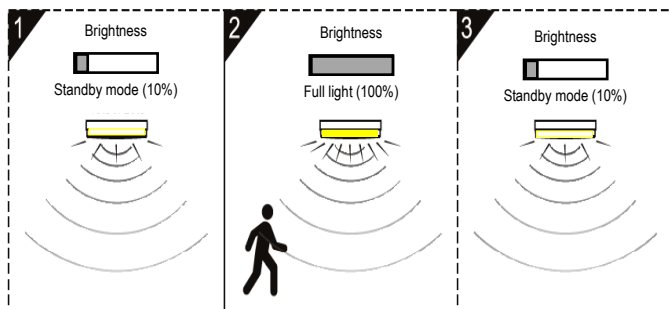

When motion is detected the fitting switches to full light.

When motion is no longer detected, after the **hold time**, the fitting returns to the standby level.

The light remains at the standby level until motion is detected again.

Sensor range	
Dipswitch ->	1
100%	ON
50%	OFF

Hold time		
Dipswitch ->	2	3
5s	ON	ON
1min	ON	OFF
5min	OFF	ON
10min	OFF	OFF

Daylight sensor			
ON	OFF	4	5
5lux	25lux	ON	ON
25lux	75lux	ON	OFF
50lux	150lux	OFF	ON
Disable	Disable	OFF	OFF

Standby time		
Dipswitch ->	6	7
0s	ON	ON
10min	ON	OFF
30min	OFF	ON
Infinity	OFF	OFF

Standby level	
Dipswitch ->	8
10%	ON
25%	OFF

Store rooms and garbage rooms

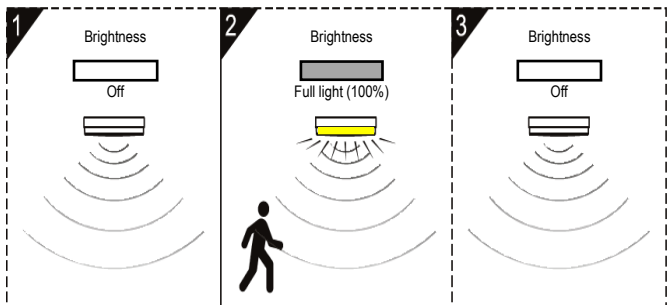

When motion is detected, the fitting switches to full light.

When motion is no longer detected, after the **hold time**, the fitting switches off.

Sensor range	
Dipswitch ->	1
100%	ON
50%	OFF

Hold time		
Dipswitch ->	2	3
5s	ON	ON
1min	ON	OFF
5min	OFF	ON
10min	OFF	OFF

Daylight sensor			
ON	OFF	4	5
5lux	25lux	ON	ON
25lux	75lux	ON	OFF
50lux	150lux	OFF	ON
Disable	Disable	OFF	OFF

Standby time		
Dipswitch ->	6	7
0s	ON	ON
10min	ON	OFF
30min	OFF	ON
Infinity	OFF	OFF

Standby level	
Dipswitch ->	8
10%	ON
25%	OFF

3-step dimming to off

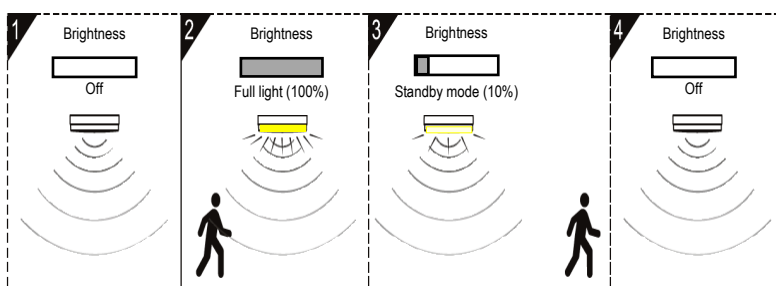

When motion is detected the fitting switches to full light.

After motion is no longer detected, after the **hold time**, the fitting dims to standby level.

Then, after the **standby time**, it will switch off.

Sensor range	
Dipswitch ->	1
100%	ON
50%	OFF

Hold time		
Dipswitch ->	2	3
5s	ON	ON
1min	ON	OFF
5min	OFF	ON
10min	OFF	OFF

Daylight sensor			
ON	OFF	4	5
5lux	25lux	ON	ON
25lux	75lux	ON	OFF
50lux	150lux	OFF	ON
Disable	Disable	OFF	OFF

Standby time		
Dipswitch ->	6	7
0s	ON	ON
10min	ON	OFF
30min	OFF	ON
Infinity	OFF	OFF

Standby level	
Dipswitch ->	8
10%	ON
25%	OFF

Using the daylight sensor

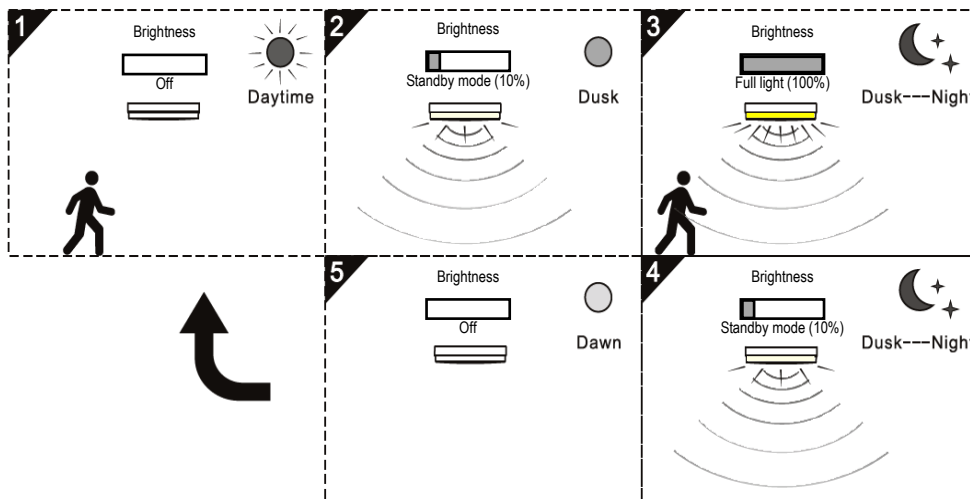

When there is sufficient natural light, the fitting remains off.

At dusk, the fitting switches to standby mode.

When motion is detected during the night, the fitting will switch to full light.

When motion is no longer detected, after the **hold time**, the fitting returns to standby mode.

Sensor range		Hold time			Daylight sensor				Standby time			Standby level	
Dipswitch ->	1	Dipswitch ->	2	3	ON	OFF	4	5	Dipswitch ->	6	7	Dipswitch ->	8
100%	ON	5s	ON	ON	5lux	25lux	ON	ON	0s	ON	ON	10%	ON
50%	OFF	1min	ON	OFF	25lux	75lux	ON	OFF	10min	ON	OFF	25%	OFF
		5min	OFF	ON	50lux	150lux	OFF	ON	30min	OFF	ON		
		10min	OFF	OFF	Disable	Disable	OFF	OFF	Infinity	OFF	OFF		

Battery replacement

This luminaire requires a change of battery when it no longer meets its rated duration of operation i.e. 90 minutes after receiving full charge. Follow the instructions below to carry out battery replacement:

All electrical work must be carried out by a licensed electrician.



Remove diffuser by twisting off.

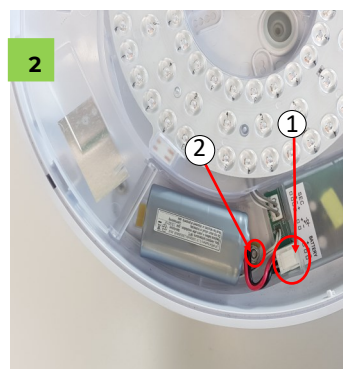

Open battery compartment and unplug battery (1). Unscrew battery using 7mm socket (2). Remove old battery.

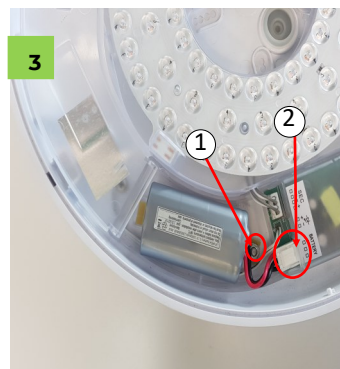

Insert new battery and secure using a 7mm socket (1). Plug battery in (2) and note date of commissioning on battery.

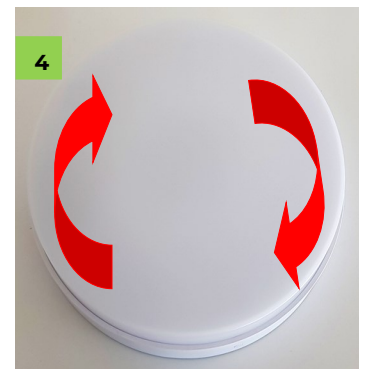

Close battery compartment and twist diffuser onto base.
Recycle old LiFePO4 battery.

Dimensions

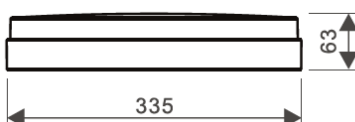

Key Luminaire Specifications					
Model	Version	Power Rating	Ambient Temperature	Emergency Classification	Battery
D2-CHAM	Sensor	220-240V 50/60Hz, 15W	0°C to +40°C	N/A	N/A
D2-CHAM-E	Sensor Emergency	220-240V 50/60Hz, 16W	0°C to +40°C	Maintained EM classification: D40	3.2V 3000mAh LiFePO4

Cleaning

To clean the fitting use a damp soft cloth. Do not use chemical cleaning products.

September 2020 E&OE