

Vico LED batten

Standard & Emergency



Installation Instructions



NOTE: All electrical work must be carried out by a licensed electrician as per the latest AS 3000 wiring regulations.

WARNING: All maintenance, such as battery change, is to be performed by qualified personnel only. De-energize all supplies before maintenance. This luminaire contains non-user replaceable lamps. Do not touch LEDs during installation or maintenance or put gear tray facing downwards onto surface.

Warranty void if LED damage found. All entry points should be sealed properly to maintain the IP65 rating of the fitting. Warranty void if water damage found.

The light must be operated within its specified operating parameters and in accordance with our warranty requirements. These documents are available on our website.

It is the responsibility of the installer to ensure the following to avoid premature battery failure:

- Emergency fitting should be installed within 3 months after purchase as extended storage may shorten the battery life
- After connecting the battery, mains power should be supplied to the fitting within 7 days.

Installation



Fix the mounting brackets to the ceiling/wall. If mounting brackets are not used, seal the screw holes to maintain IP65 rating.

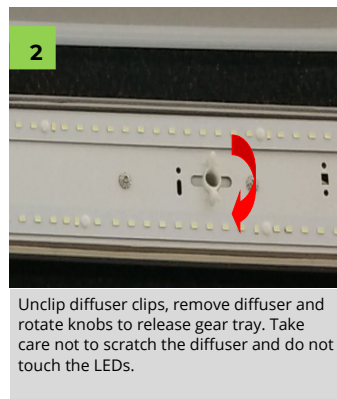

Unclip diffuser clips, remove diffuser and rotate knobs to release gear tray. Take care not to scratch the diffuser and do not touch the LEDs.

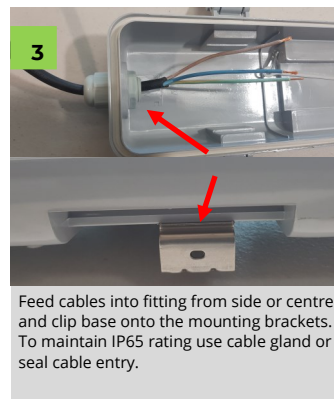

Feed cables into fitting from side or centre and clip base onto the mounting brackets. To maintain IP65 rating use cable gland or seal cable entry.

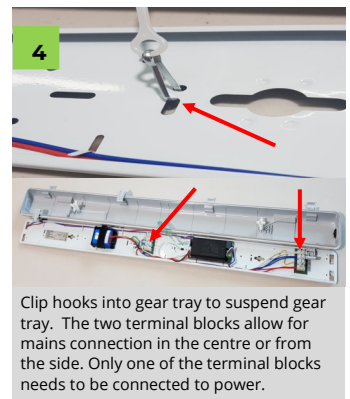

Clip hooks into gear tray to suspend gear tray. The two terminal blocks allow for mains connection in the centre or from the side. Only one of the terminal blocks needs to be connected to power.

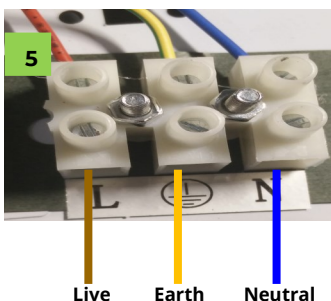

Wiring of non-emergency fitting.

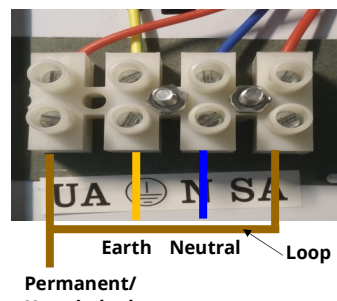

Permanent/
Unswitched
Active

Wiring of emergency fitting with only unswitched active present. Insert loop between UA and SA terminal.

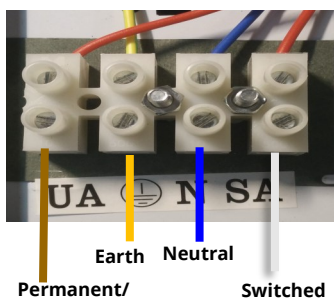

Permanent/
Unswitched
Active

Switched
Active

Wiring of emergency fitting with switched and unswitched active present

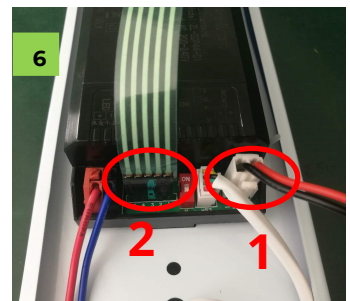

Emergency models: Plug battery plug (1) and indicator cable (2) into the driver. Raised imprint and ink marking should be facing away from driver. Write the date of commissioning on the battery.

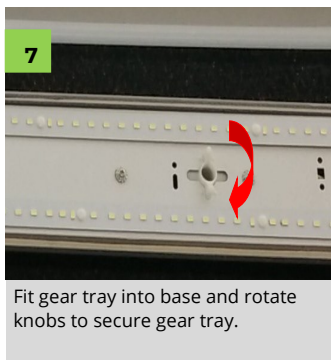

Fit gear tray into base and rotate knobs to secure gear tray.

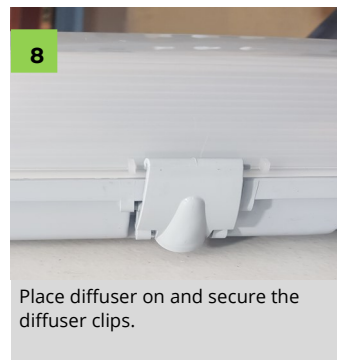

Place diffuser on and secure the diffuser clips.

The emergency light requires permanent electrical supply and permanent active must not be switched. The permanent active **and** switched active have to be energised for the fitting to illuminate. If the switched active is turned off then the battery will charge but the fitting will not illuminate in normal mode.

Half Power Switch

In areas where less light is required, the full and standby power can be set to half. **Default setting: Full power.**

	Half power switch	Operating mode
I	ON	Half power
II	OFF	Full power

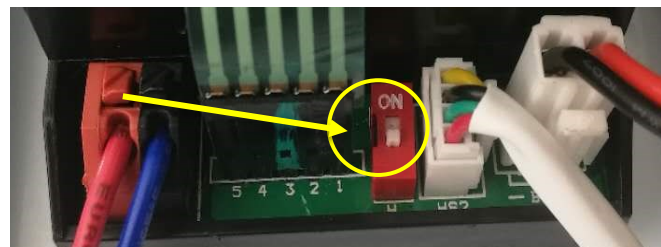

Microwave Sensor Settings

The microwave sensor inside the diffuser is an active motion detector that emits a high frequency electro-magnetic wave (5.8GHz) and receives its echo. If it is necessary to check or adjust microwave sensor settings to suit the local conditions, remove the diffuser.

The microwave sensor is inside the diffuser →

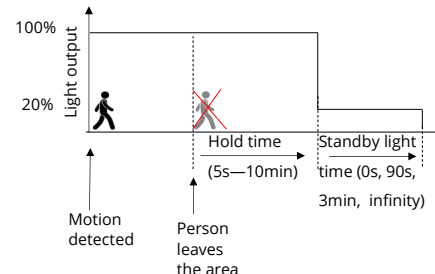
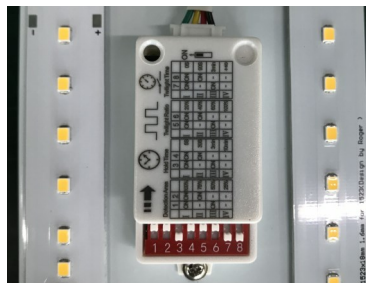

Detection Area

Sensitivity can be adjusted to suit local conditions.

If the sensor detects motion outside the desired detection area, reduce detection area setting to a lower value. **Default setting: 100%.**

Detection Area		
Dipswitch→	1	2
100%	ON	ON
75%	OFF	ON
50%	ON	OFF
25%	OFF	OFF

Hold Time

Refers to the time the luminaire remains at 100% after motion is no longer detected. Recommended value: 30 seconds for stairwells/ corridors, 3 minutes for car park parking bays. **Default setting: 30s**

enLighten recommends to use permanently-on fittings in driveways.

Hold Time		
Dipswitch→	3	4
5 seconds	ON	ON
30 seconds	OFF	ON
3 minutes	ON	OFF
10 minutes	OFF	OFF

Standby Light Level

Refers to the illumination level after motion is no longer detected. Light can also be set to permanently-on. **Default setting: 20%.**

Standby Level (Twilight Ratio)		
Dipswitch→	5	6
20%	ON	ON
100% (light permanently-on / sensor disabled)	OFF	OFF

Standby Light Time

Refers to the time period the luminaire remains at the standby level before switching off. Recommended value: Infinity - the fitting remains at standby level during periods of no occupancy. **Default settings: infinity.**

Standby Light Time		
Dipswitch→	7	8
0 seconds (no standby)	ON	ON
90 seconds	OFF	ON
3 minutes	ON	OFF
Infinity (always in 20% standby)	OFF	OFF

Battery Replacement

This luminaire requires a change of battery when it no longer meets its rated duration of operation i.e. 90 minutes after receiving full charge. Follow the instructions below to carry out battery replacement:

All electrical work must be carried out by a licensed electrician.

1. Isolate unit from mains power;
2. Remove diffuser and release gear tray;
3. Unplug battery plug from driver;
4. Remove battery from battery holder;
5. Insert new battery into battery holder, write the date of commissioning on the battery;
6. Plug battery cable into driver;
7. Secure gear tray and diffuser onto luminaire base;

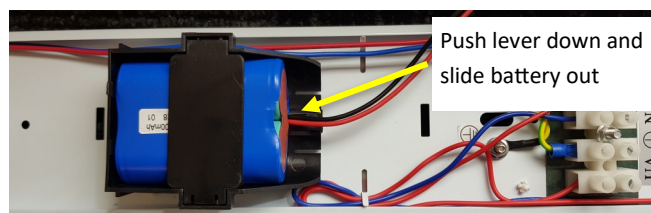

The battery is in a battery holder on the gear tray.

Emergency Models: Indicator & Simulation of Normal Power Supply Failure

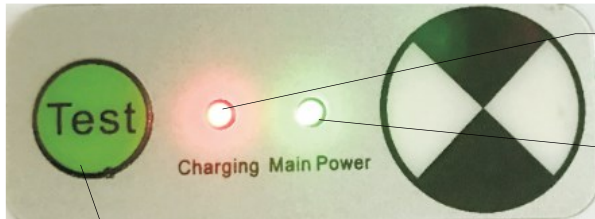

Red LED **ON** = Charging
Red LED **OFF** = Battery fully charged

Green LED **ON** = Mains supply active
Green LED **OFF** = Mains supply failure

TEST BUTTON Press & hold the Test button to simulate normal power supply failure. This will trigger emergency mode switching LED supply from 240V supply to battery. Releasing the button will restore normal power to the luminaire.

Key Luminaire Specifications

Model	Version	Power Rating	Ambient Temperature	Emergency Classification	Battery
BL15ES	Sensor Emergency	220-240V 50/60Hz, 42W	0°C to +40°C	Maintained C0: D63; C90: D40	6.4V 3000mAh LiFePO4, part no. BL-BATT-LI
BL15E	Emergency	220-240V 50/60Hz, 42W	0°C to +40°C	Maintained C0: D63; C90: D40	6.4V 3000mAh LiFePO4, part no. BL-BATT-LI
BL15S	Sensor	220-240V 50/60Hz, 42W	-25°C to +40°C	N/A	N/A
BL15	Standard	220-240V 50/60Hz, 42W	-25°C to +40°C	N/A	N/A
BL12ES	Sensor Emergency	220-240V 50/60Hz, 30W	0°C to +40°C	Maintained C0: D63; C90: D40	6.4V 3000mAh LiFePO4, part no. BL-BATT-LI
BL12E	Emergency	220-240V 50/60Hz, 30W	0°C to +40°C	Maintained C0: D63; C90: D40	6.4V 3000mAh LiFePO4, part no. BL-BATT-LI
BL12S	Sensor	220-240V 50/60Hz, 30W	-25°C to +40°C	N/A	N/A
BL12	Standard	220-240V 50/60Hz, 30W	-25°C to +40°C	N/A	N/A
BL06ES	Sensor Emergency	220-240V 50/60Hz, 16W	0°C to +40°C	Maintained C0: D80; C90: D32	6.4V 3000mAh LiFePO4, part no. BL-BATT-LI
BL06E	Emergency	220-240V 50/60Hz, 16W	0°C to +40°C	Maintained C0: D80; C90: D32	6.4V 3000mAh LiFePO4, part no. BL-BATT-LI
BL06S	Sensor	220-240V 50/60Hz, 16W	-25°C to +40°C	N/A	N/A
BL06	Standard	220-240V 50/60Hz, 16W	-25°C to +40°C	N/A	N/A

C0 & C90 Orientation
for Emergency Luminaire

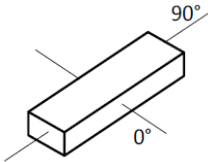

Dimensions

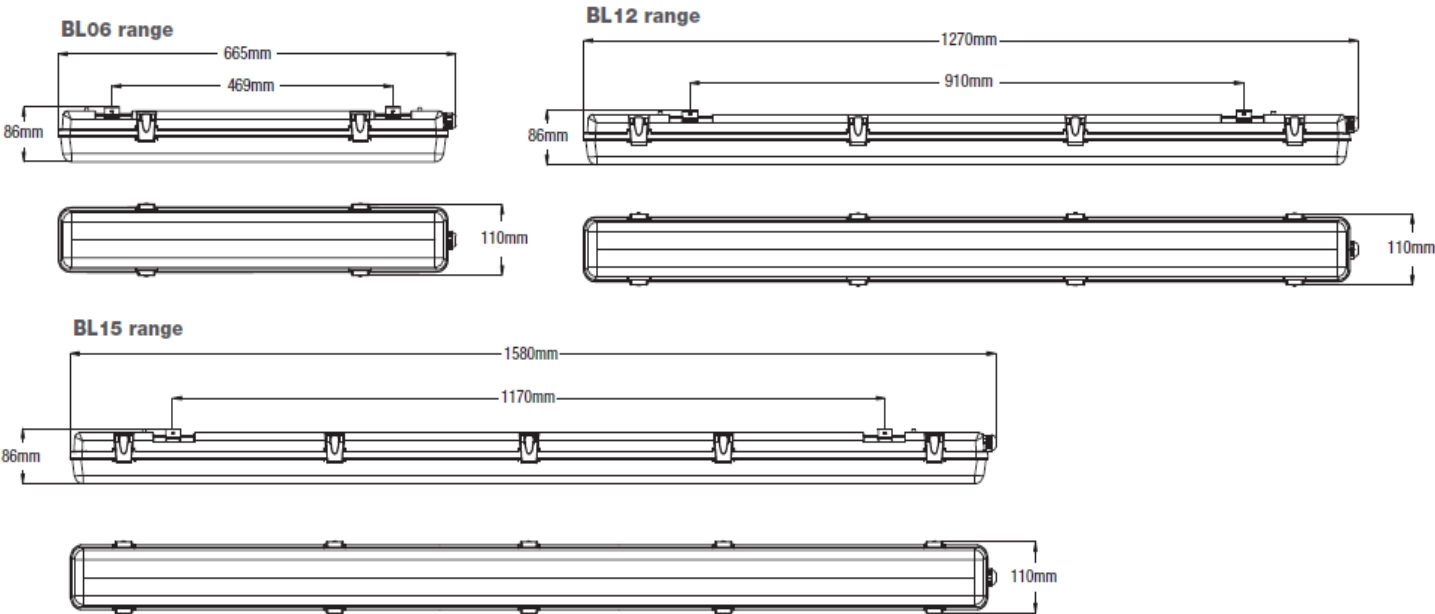

January 2021 E&OE