

Skyline LED panel



Installation Instructions



NOTE: All electrical work must be carried out by a licensed electrician as per the latest AS 3000 wiring regulations.
WARNING: All maintenance is to be performed by qualified personnel only. De-energize all supplies before maintenance.
This luminaire contains non-user replaceable lamps. Do not disassemble the panel as this will void the warranty.

The light must be operated within its specified operating parameters and in accordance with our warranty requirements. These documents are available on our website.

The LED driver must be connected to the panel before the driver is connected to mains power to avoid damage to the LEDs. Indoor use only.

Please note: The LED drivers may be packed separately from the panels.

Non-dimmable Drivers

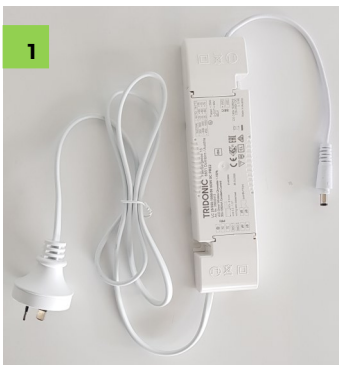

The drivers are pre-wired with a mains and DC plug.

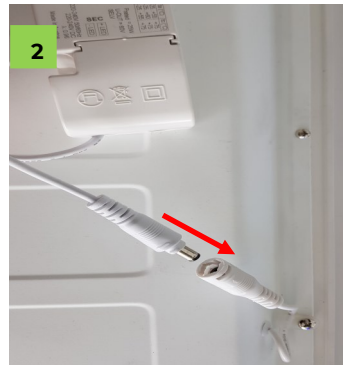

Connect DC plug to the plug on panel and twist plug to lock. Then plug driver into mains power.

DALI-2/DSI Drivers



The DALI-2/DSI drivers are pre-wired with a mains and DC plug.

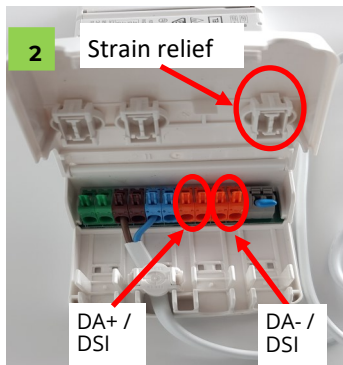

Open cover and connect DALI or DSI wires into DALI terminals. DALI/DSI wires can be looped in and out. Use cable clamps as strain relief. Close cover.

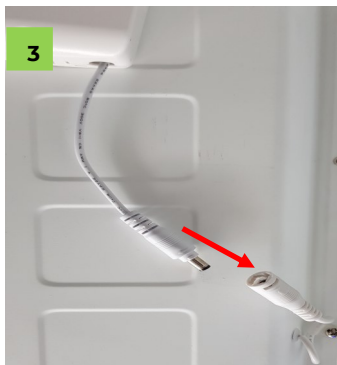

Plug DC plug of driver into panel and twist to lock. Then plug driver into mains power.

Wiring for Switch-Dim Function (DALI-2/DSI drivers only)

The Switch-Dim function allows connection of a push-button for dimming up to 25 drivers. The push-button operation is as follows:

- Short press (50-600ms) turns lights on/off
- Long press (>600ms) varies lights between 1% and 100% brightness. Release to set lights at the desired light level
- If lights connected to the push-button are at different dim levels, press and hold for 20s to synchronise the lights to the same level.

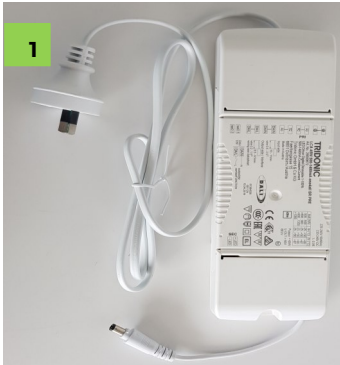

The Switch-Dim drivers are pre-wired with a mains plug DC plug.

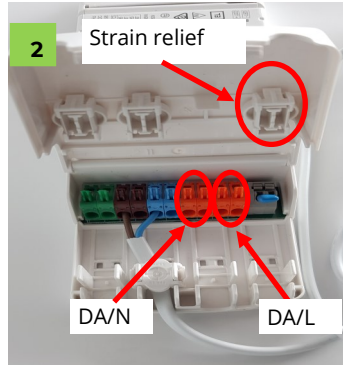

Open cover and connect switch-dim wires into DALI terminals as shown in diagram on right. Connect the switched wire from the push-button to DA/L terminal on the driver. Wires can be looped in and out. Use cable clamps as strain relief. Close cover.

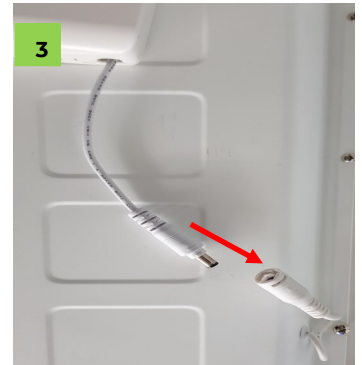
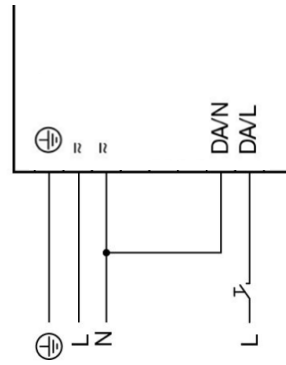

Plug DC plug of driver into panel and twist to lock. Then plug driver into mains power.

Casambi Ready Drivers CASAMBI

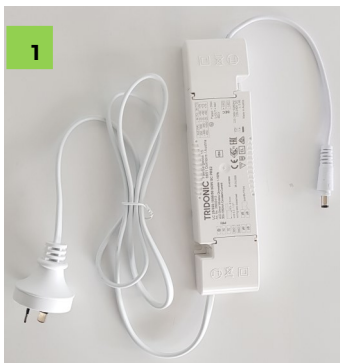

The Casambi drivers are pre-wired with a mains plug and DC plug.

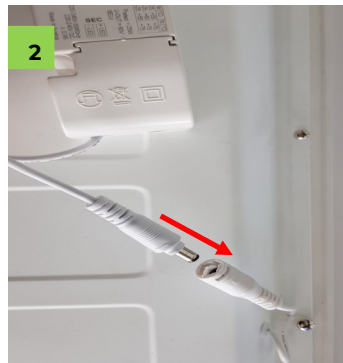

Connect DC plug to plug on panel then plug driver into mains power.



www.casambi.com

User manual & download links for the Casambi app are available at www.casambi.com

Installation

Recess Mount (T-bar Ceiling)

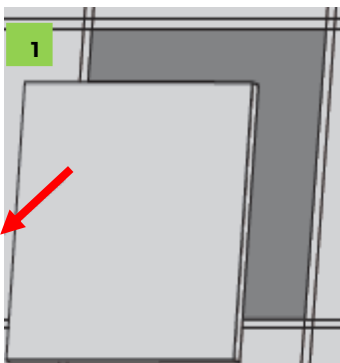

Remove ceiling tile or old luminaire.

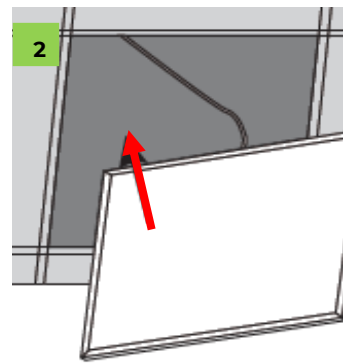

Connect driver as shown above then insert panel into opening.

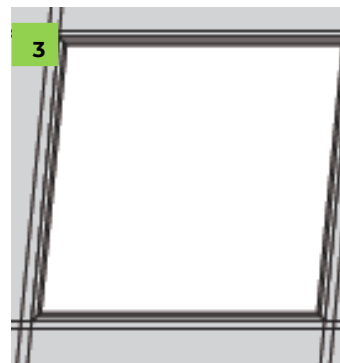

Ensure panel sits flush with the ceiling grid.

Surface Mount using Surface Mount Frame

1



Fix surface mount frame to ceiling

2



Connect driver as shown on previous pages. Lift panel at a slight angle into the frame, then lower the light flush with the frame.

SM-001

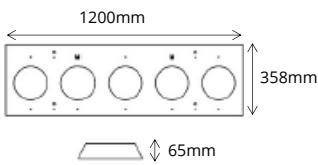

SM-002

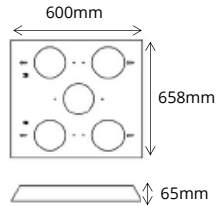

SM-003

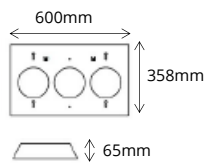

Part #	Dimensions	Fits Skyline models
SM-001	1200 x 358 x 65mm	SKY1230
SM-002	600 x 658 x 65 mm	SKY6060
SM-003	600 x 358 x 65 mm	SKY6030

Recess Mount (Plaster Frame)

1

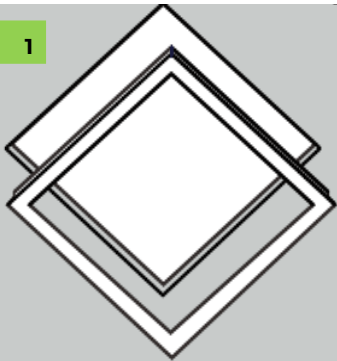

Cut hole in ceiling, see cut-out sizes below. Then insert frame into hole.

2

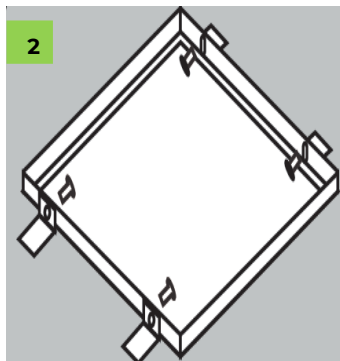

Secure recess frame in the hole.

3

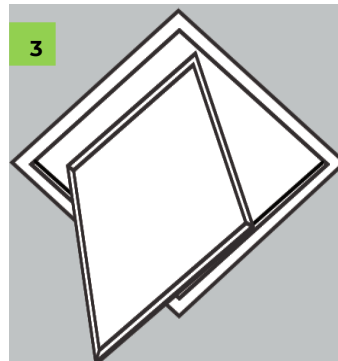

Connect driver as shown on previous pages, then insert panel into frame and ensure it sits flush with the frame.

R-001



R-002



R-003

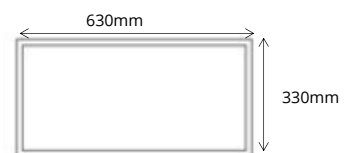

Part #	Dimensions	Cut-out size	Fits Skyline models
R-001	1230 x 330 x 40mm	1210 x 310mm	SKY1230
R-002	630 x 630 x 40mm	610 x 610 mm	SKY6060
R-003	630 x 330 x 40 mm	610 x 310 mm	SKY6030

August 2021 E&OE